

Technical data sheet

Product features



Multifunctional kitchen appliance INFINITY 5x GN 1/1

Model	SAP Code	00010704
--------------	-----------------	----------



- Shock cooling cycle kg / min (+3 ° C): 25 / 90
- Shock freeze cycle kg / min (-18 ° C): 15 / 240
- Maximum device temperature [°C]: -40
- Probe: 4-points
- Insulation thickness [mm]: 80
- Control type: Touchscreen
- Display size: 9"
- User programmable cycles: Yes, with save options
- Thaving cycle: Yes
- Proving cycle: Yes

SAP Code	00010704	Number of GN / EN	5
Net Width [mm]	790	GN / EN size in device	GN 1/1
Net Depth [mm]	839	GN device depth	65
Net Height [mm]	847	Shock cooling cycle kg / min (+3 ° C)	25 / 90
Net Weight [kg]	100.00	Shock freeze cycle kg / min (-18 ° C)	15 / 240
Power electric [kW]	0.578	Control type	Touchscreen
Loading	230 V / 1N - 50 Hz		

Technical data sheet

Technical drawing



Multifunctional kitchen appliance INFINITY 5x GN 1/1

Model

SAP Code

00010704

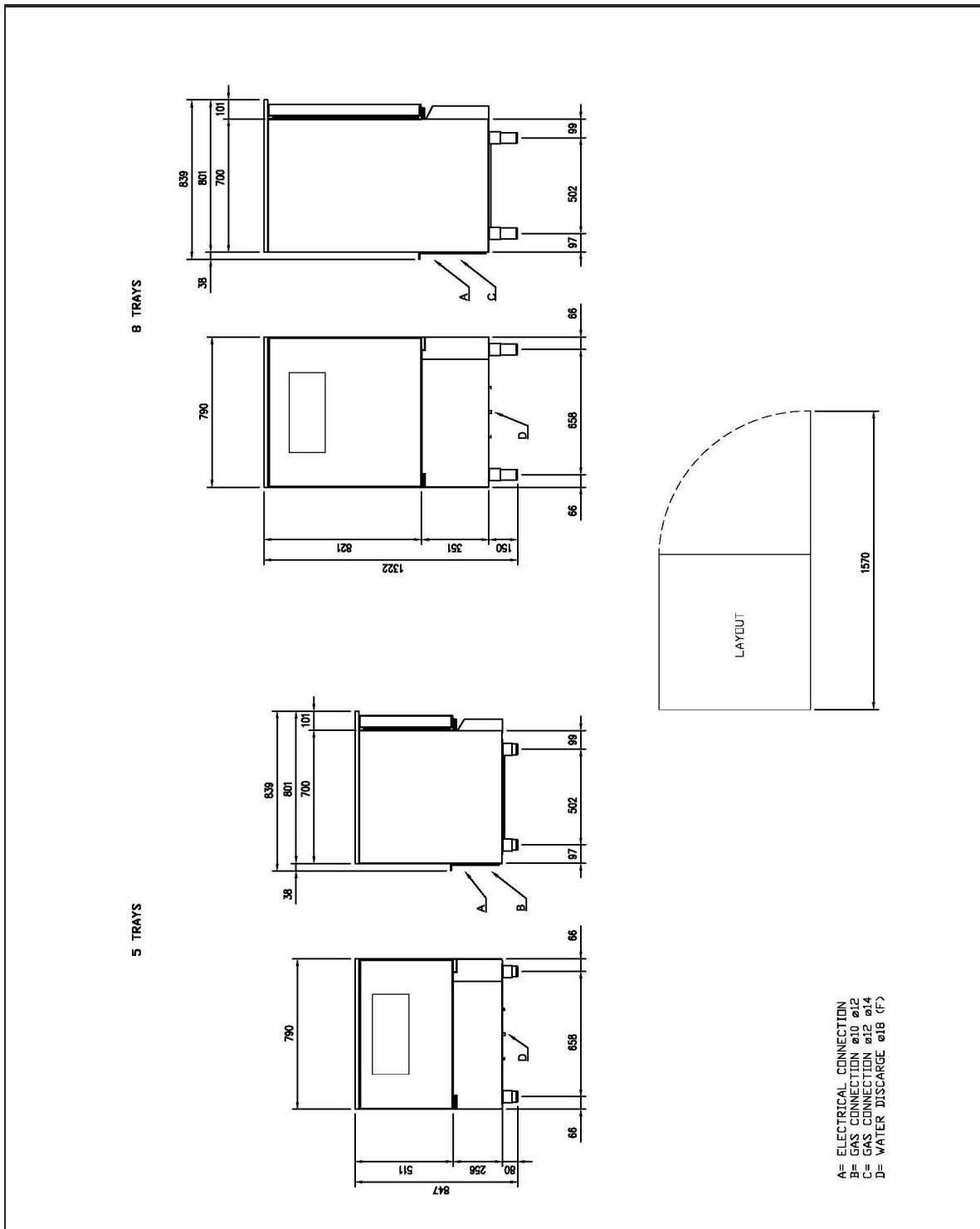

Technical data sheet

Product benefits



Multifunctional kitchen appliance INFINITY 5x GN 1/1

Model

SAP Code

00010704

1

6 in 1

can replace 6 devices (fridge, freezer, shocker, hotbox, kitchen, oven)

- saves space, time, energy and the cost of additional equipment due to the enormous variability

2

Stainless steel body and interior

endurance
hygiene

- thanks to the all-stainless steel construction it is very easy to maintain and thus saves costs

3

Monitoring of HACCP parameters

easy registration of all necessary parameters

- hassle-free proof of proper food handling in the event of an inspection

4

Preset cycles

very simple and intuitive operation

- operation can be handled by less qualified operators

5

Slow cooking

better taste
less weight loss during cooking

- saves costs due to less weight loss

6

Multipoint probe

precise monitoring of the cooling/freezing/
cooking temperature

- the probe makes it easier to ensure food safety
- saves energy and time due to the end of cooling/freezing/cooking when temperature is reached

7

Thawing

readiness of frozen food for processing on time

- time saving
- controlled food handling

8

Cooking during the night

the possibility to preset entire program cycles and run them overnight unattended

- saving equipment capacity during the day
- saving of human capacity and time due to unattended operation of the equipment overnight

Technical data sheet

Technical parameters



Multifunctional kitchen appliance INFINITY 5x GN 1/1

Model

SAP Code

00010704

1. SAP Code:

00010704

2. Net Width [mm]:

790

3. Net Depth [mm]:

839

4. Net Height [mm]:

847

5. Net Weight [kg]:

100.00

6. Gross Width [mm]:

846

7. Gross depth [mm]:

860

8. Gross Height [mm]:

980

9. Gross Weight [kg]:

116.60

10. Device type:

Electric unit

11. Material:

Stainless steel

12. Exterior color of the device:

Stainless steel

13. Opening of device:

Hinges on the left

14. Power electric [kW]:

0.578

15. Loading:

230 V / 1N - 50 Hz

16. Control type:

Touchscreen

17. Display size:

9"

18. Refrigerant:

R452a

19. Number of GN / EN:

5

20. GN / EN size in device:

GN 1/1

21. GN device depth:

65

22. Maximum device temperature [°C]:

-40

23. Shock freeze cycle kg / min (-18 ° C):

15 / 240

24. Shock cooling cycle kg / min (+3 ° C):

25 / 90

25. Insulation thickness [mm]:

80

26. Long-term cooling function:

Yes

27. Longterm freezing function:

Yes

28. Number of fans:

1

Technical data sheet

Technical parameters



Multifunctional kitchen appliance INFINITY 5x GN 1/1

Model

SAP Code

00010704

29. Probe:

4-points

30. Self-diagnostics:

Yes

31. HACCP:

Yes

32. Low temperature heat treatment:

Yes

33. Low temperature cooking span [°C]:

52 - 85

34. Delta T heat preparation:

Yes

35. Delayed start:

Yes

36. Thaving cycle:

Yes

37. Proving cycle:

Yes

38. Automatic defrost:

Yes

39. Adjustable feet:

Yes

40. User programmable cycles:

Yes, with save options

41. USB port:

Yes, for HACCP and firmware update

42. Castors:

Optional

43. Real time monitoring paramaters:

Energy consumption, Chamber temperature, Probe temperature, Graph with the course of temperature and consumption

44. Cross-section of conductors CU [mm²]:

0,5

- Výkon (kW): 2,4-3,3 (230 V)